





**RDC 200 Hot Water Storage Tank**

 <p><b>RDC 200</b></p>	<b>Main features</b>	
	Application	DHW heating
	Description	hot water storage tank with integrated enamelled heat exchanger, permitting installation of an el. heating element
	Working fluid	water (tank), water or water/glycol mixture (max. 1:1) (heat exchanger)
	<b>Code</b>	<b>12 758</b>
	<b>Energy Efficiency Data (as per EC Regulation No. 813/2013)</b>	
		<b>RDC 200</b>
	Energy efficiency class	<b>C</b>
	Standing loss	<b>82 W</b>
	Storage volume	<b>208 l</b>
	<b>Technical data</b>	
	Total tank volume	216 l
	Fluid volume in tank	208 l
	Heat exchanger (HE) volume	8 l
	Heat exchanger surface area	1,0 sqm
	Max. working temperature in tank	95 °C
	Max. working temperature in HE	110 °C
	Max. working pressure in tank	10 bar
	Max. working pressure in HE	10 bar
	<b>Hot water heating from 10 °C to 45 °C at heating water temp. of 60 °C</b>	
	Heat exchanger	590 l/h (24 kW)
<b>Materials</b>		
Tank material	S235JR, inner surface enamelled (DIN 4756)	
Heat exchanger material	S235JR+N, outer surface enamelled (DIN 4756)	
Tank perimeter insulation	PU foam (hard)	
Tank perimeter insulation's outer	plastic	
<b>Dimensions, Tipping height, Weight</b>		
Tank diameter	500 mm	
Tank diameter with insulation	584 mm	
Tank overall height	1352 mm	
Tipping height	1480 mm	
Empty weight	97 kg	
<b>Accessories</b>		
El. heating element	models ETT-A, D, F, G, M	
Heating elem. max. length / output	495 mm / 6,0 kW	
Electronic anode rod	code 9 174	
<b>Spare parts</b>		
Magnesium anode rod (G 5/4")	code 448	
Magnesium anode rod (G 5/4") with flange and gasket	code 15 847	
<p><b>El. heating element</b></p> <p>model A </p> <p>model M </p> <p><b>Magnesium anode rod</b></p> 		

**RDC 200 Hot Water Storage Tank**

**Heat exchanger pressure drop**

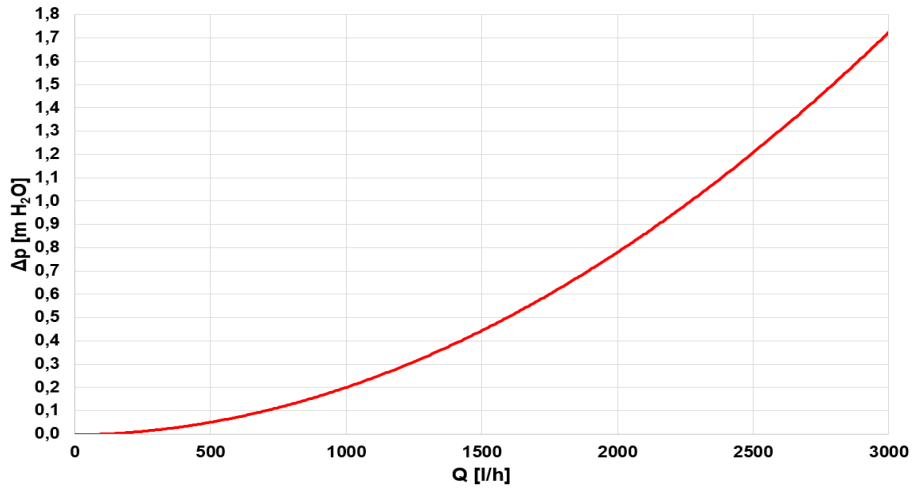

**Dimensions**

Tipping height 1480 mm.

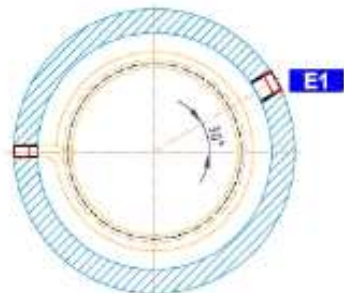
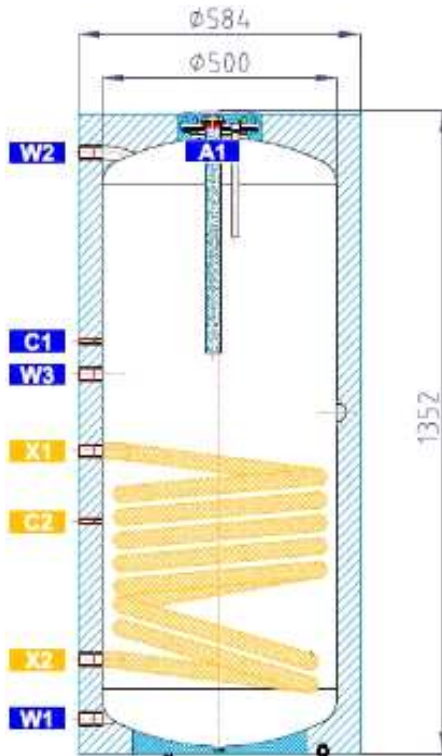

**TAPPINGS**

pos.	connection	height [mm]
<b>DHW heating</b>		
W1	G 3/4" F	68,5
W2	G 3/4" F	1268,5
W3	G 3/4" F	810
<b>El. heating elements</b>		
E1	G 6/4" F	670
<b>Control and safety</b>		
C1	G 1/2" F	910
C2	G 1/2" F	345
<b>Solar thermal system</b>		
X1	G 3/4" F	638,5
X2	G 3/4" F	198,5
<b>Magnesium anode rod</b>		
A1	G 5/4" F	1330